



KEY FEATURES

- Front Rear and Side Access.
- Fully adjustable vertical rails front and rear.
- 13mm Plywood Backboard in End Bay.
- Doors complete with 3-point lock and secondary security lock system.
- Apex roof.
- Large open base entry.
- Fully welded construction.
- Fully vented complete with 3-fan assembly main cabinet, single fan assembly in End Bay.
- Also available in 304 or 316 stainless.
- Available in Black, Green or Grey as standard, other colours available on request.
- IP65 rated.
- Base bolt hole on all four sides, M20.

Available Dimension

Height (mm)	Width (mm)	Depth (mm)	Capacity
1000	1050	650	15u
1300	1050	650	20u
1300	1050	650	24u
1300	1050	800	20u
1300	1050	800	24u

FOX – Front Rear Access with End Bay External Cabinet.

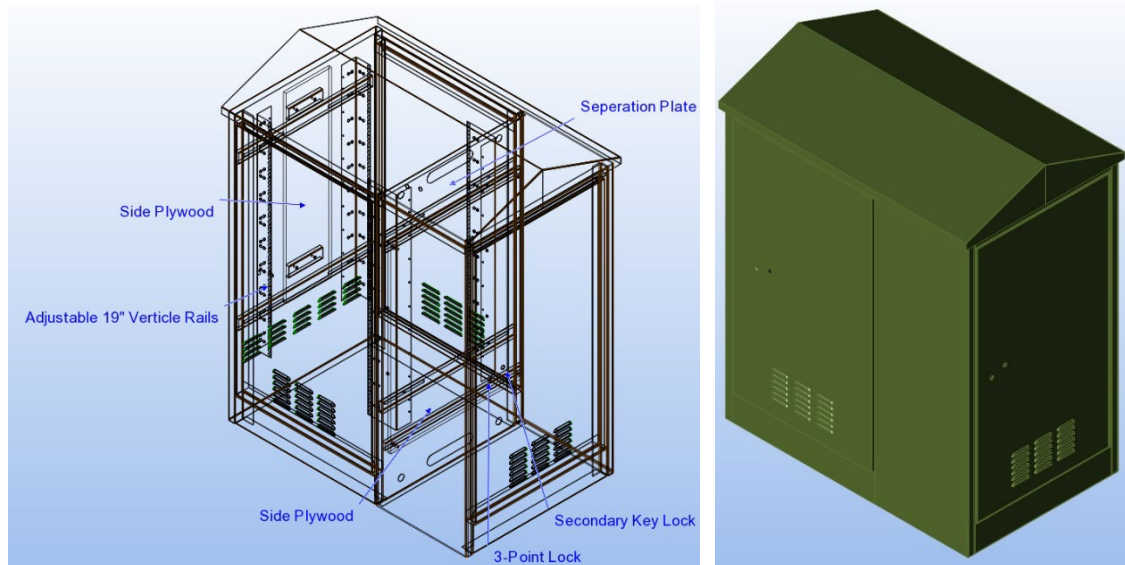

FDMS 650 Front Rear and side Access Cabinets are designed for external use, manufactured from 2mm thick 4003 stainless, the fully welded Construction ensures the Cabinets are robust and suitable for heavy-duty applications.

The fully adjustable rail system allows the 19” vertical rails to be fitted at the front and rear of the cabinet which can be set by the customer offering a wide range of depths for equipment mounting.

FDMS 650 Front Rear and Side Access Cabinets are supplied with a set of 19” vertical rails Front and Rear, complete with cable management fitted along the side of the righthand vertical rails both front and rear, End Bay fitted with plywood backboard.

Ventilation is provided through louvres manufactured within the front lower sections of the doors. The cabinets are supplied with three thermostatically controlled fans in the roof with the main cabinet and single fan assembly within the end bay, all extraction points protected with mesh screen to prevent against vermin and insects.

FDMS 650 Cabinets are designed to be bolt directly to a concrete slab, increased height can be achieved for the likes of battery storage by adding an extension plinth.

Cabinet 650 Front Rear and side access comes complete with 3-point locking secured by a secondary security key lock, as a single module it is part of a much larger family of our cabinets, please refer to our website www.fdns.co.uk for details.

Special Bespoke sizes also available to customer requirements.

T: 01352 733373, E: sales@fdms.co.uk

